

CURVE	ARC LENGTH	RADIUS	DELTA	CHORD BRG	CHORD LENGTH
C1	110.87'	255.00'	24°54'42"	N 68°08'27" W	110.00'
C2	110.87'	255.00'	24°54'42"	N 43°13'45" W	110.00'
C3	147.08'	255.00'	33°02'48"	N 14°15'00" W	145.05'
C4	56.19'	205.00'	15°42'14"	N 05°34'43" W	56.01'
C5	27.55'	35.00'	45°05'57"	N 35°58'49" W	26.84'
C6	37.76'	50.00'	43°15'52"	N 36°53'51" W	36.86'
C7	70.76'	50.00'	81°05'00"	N 25°16'35" E	65.00'
C8	70.76'	50.00'	81°05'00"	S 73°38'26" E	65.00'
C9	56.52'	50.00'	64°46'03"	S 00°42'55" E	53.56'
C10	9.93'	35.00'	16°15'37"	S 23°32'18" W	9.90'
C11	17.62'	35.00'	28°50'20"	S 00°59'20" W	17.43'
C12	69.89'	255.00'	15°42'14"	S 05°34'43" E	69.67'
C13	42.01'	205.00'	11°44'25"	S 03°35'49" E	41.93'
C14	271.84'	205.00'	75°58'37"	S 47°27'19" E	252.36'
C15	22.03'	258.81'	4°52'34"	N 83°03'10" W	22.02'

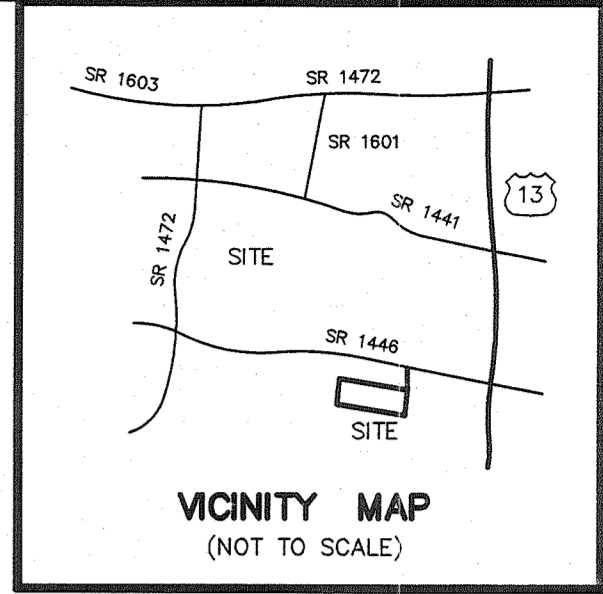

- LINE LEGEND:**
- Subject Tract Surveyed
 - Setback Lines
 - Lot Lines
 - Easement Line
 - Road Centerline
 - Surveyed Lines, R/W or Tie Line
 - Not to Scale

- LEGEND:**
- FIP Found Iron Pipe
 - SIP Set Iron Pipe
 - FCM Found Concrete Monument
 - PKS Found P.K. Nail
 - FRB Set P.K. Nail
 - SRB Found Rebar
 - R/W Set Rebar
 - CP Right of Way
 - CL Centerline
 - CP Computed Point
 - FRRS Found Railroad Spike
 - SRRS Set Railroad Spike
 - AXF Found Axle
 - FLK Found Lightwood Knot

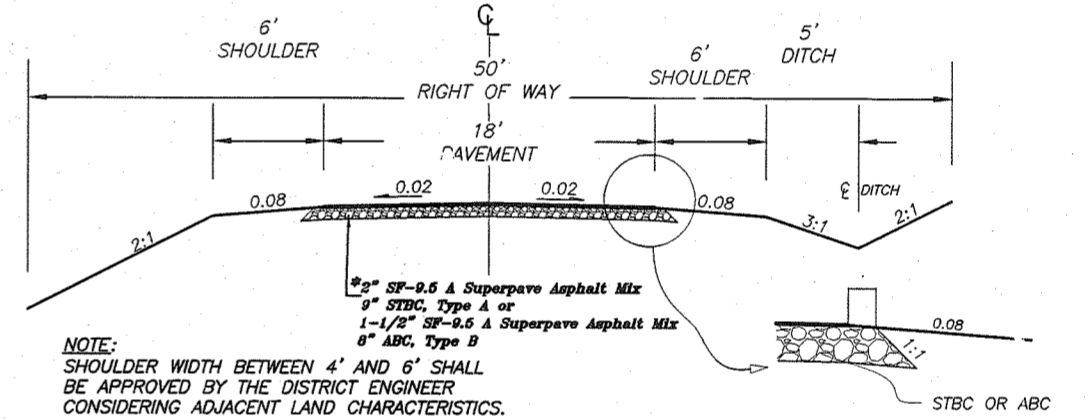

* SUBJECT TO STANDARDS OUTLINED ON PAGE 46 OF THE NC SUBDIVISION ROADS MINIMUM CONSTRUCTION STANDARDS AND ENGINEERED FIELD SOILS TESTS.

State of North Carolina
County of Sampson

I, _____ Review Officer of Sampson County, certify that the map or plat to which this certification is affixed meets all statutory requirements for recording.

Date _____ Review Officer _____

NORTH CAROLINA
SAMPSON
COUNTY

This Map/ Plat was presented for registration and recorded in this office at Map Book 109 Page 19
This 11 day of September at 10:49 o'clock
A.M.

ELEANOR N. BRADSHAW
Register of Deeds
By: Beth E. Harvey
Asst. Deputy Register of Deeds

DEPARTMENT OF TRANSPORTATION
DIVISION OF HIGHWAYS

APPROVED: KJB
Date: 9/15/18

This is to certify that I have Consulted the Federal Insurance Administration Flood Hazard Boundary Maps and found that the above property described IS NOT located in a special flood hazard area.

NORTH CAROLINA
HARNETT COUNTY

I, J. Scott Walker, a Professional Land Surveyor, certify that this plat was drawn under my supervision from an actual survey made under my supervision (deed description recorded per deed references as stated on map), that the ratio of precision as calculated by latitude and departures is 1/10000+, that the boundaries not surveyed are shown as broken lines plotted from information as shown on map, that this plat was prepared in accordance with G.S. 47-30 as amended. Witness my original signature, registration number, and seal this 10th day of August, A.D., 2018.



J. Scott Walker
Surveyor
L-4332
Registration Number

FINAL PLAT
FINAL PLAT FOR:
**MILL RIDGE SUBDIVISION
PHASE 3**
PROPERTY OF:
TEW LAND DEVELOPMENT, LLC
A North Carolina Limited Liability Company

P.O. Box 1308, Dunn, NC 28335
DISMAL TWP., SAMPSON CO., N.C.
DRAWN BY: J. SCOTT WALKER
835 Abbatior Road, Coats NC 27521
Phone: (910) 897-5753

JULY 26, 2018
GRAPHIC SCALE

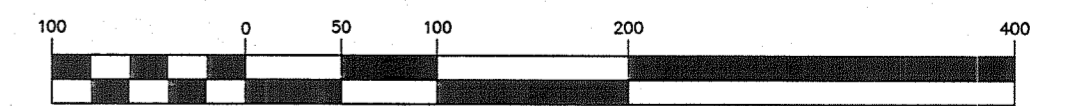

(IN FEET)
1 inch = 100 ft.
PIN: 02100532013 APN: 1511-#014

Sheet 1 of 2
REVISION: AUGUST 10, 2018

LYNN CAREY TEW
Deed Book 1882, Page 696
Map Book 85, Page 34

CARLTON C. MARTIN
Deed Book 1210, Page 581
Map Book 22, Page 37

KANSAS CITY
SAUSAGE COMPANY LLC
Deed Book 1900, Page 606

MARVIN F. TEW, JR.
Deed Book 035
Page 175

MARVIN F. TEW, JR.
Deed Book 1936
Page 229

ROY V. TEW, III
Deed Book 1862
Page 736
Map Book 85
Page 34
PIN: 02100536003
APN: -1511

MILL RIDGE SUBDIVISION
Phase 1
Map Book 56, Page 53

WATERWHEEL LN
50' R/W

"AUTRY MILL ROAD"
SR 1446 60' R/W

CERTIFICATE OF APPROVAL FOR RECORDING

I hereby certify that the subdivision plat shown hereon has been found to comply with the Subdivision Regulations of the County of Sampson, North Carolina and that this plat has been approved for recording in the Office of the Register of Deeds of Sampson County

See Page 2
Administrator
chairman Board of Commissioners